

Package content MAFI 3623

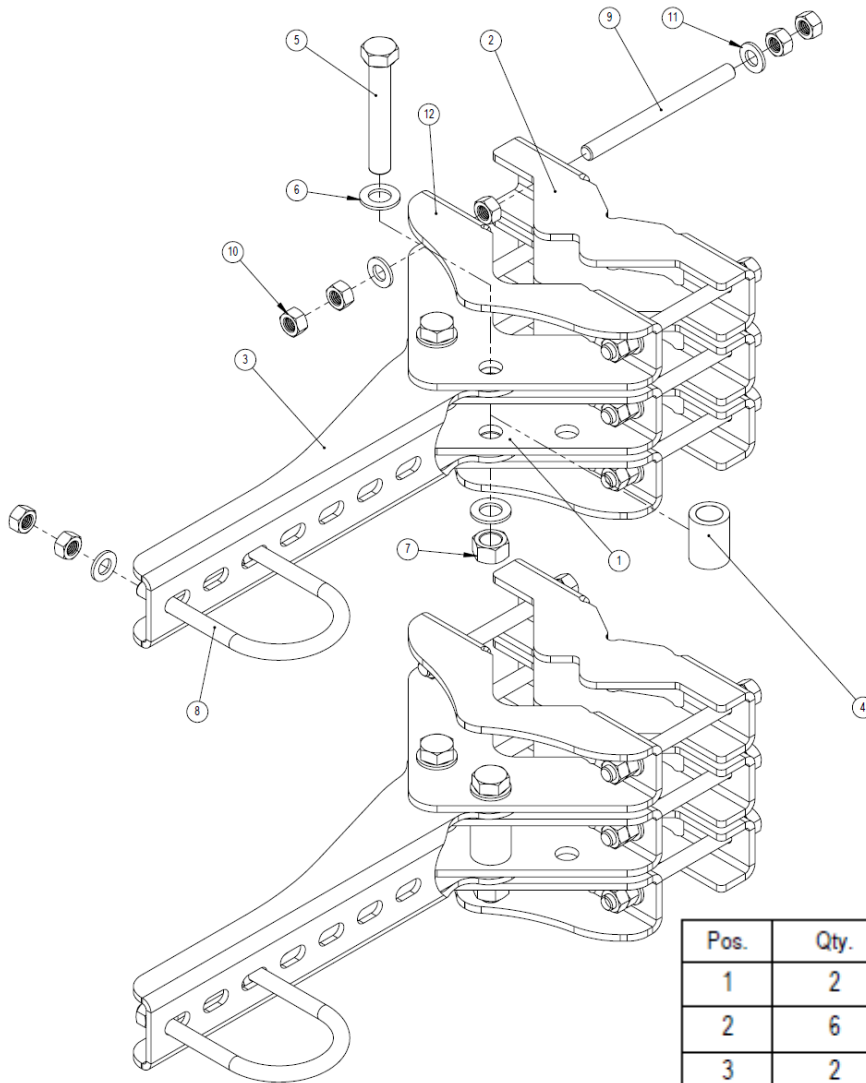

Pos.	Qty.	Description
1	2	Front clamp
2	6	Back clamp
3	2	Offset arm long
4	4	Bushing M16 x 40 mm
5	4	Bolt M16 x 100
6	8	Washer 17 x 30 x 2.5
7	4	Nut M16
8	2	U-bolt kit M12 x 91 C-C 92 Type A
9	12	Threaded rod M12 x 150
10	60	Nut M12
11	24	Washer 13 x 24 x 2.5
12	4	Front clamp

ISO standard tools (Not included):
 Block key: M12, M16
 Torque wrench: M12: 31 Nm
 M16: 210 Nm

Follow local building regulations and instructions and ensure use of approved fasteners. MAFI AB, the product manufacturer, does not warrant other than the product during mounting onto roof or other similar assemblies.

The tightening torques recommended in this mounting description presupposes bolts and nuts in delivery state. Nuts are to be lubricated before assembling. Check that the supporting structure can safely carry the loads applied to it by the MAFI product.

Mounting procedure

